

EPDM lined split-ring type pipe clamps with integral fixing nuts. Suitable for ceiling suspension or vertical wall mounting of piping. Designed with a number of features which enhance product performance and reliability.

## Features

- EPDM Lining - Easyflex clamps have high grade EPDM lining, which is significantly superior in terms of product life compared to commercial grade rubber as provided by some others.
- Both halves of the clamp are ribbed, for greater strength.
- Long thread engagement - All Easyflex EFRLC series split clamps are designed with extended thread lengths on the lips of the upper half. This ensures safer installation than clamps offered by others, that have barely one thread engagement also prevents loosening of the clamp's grip over a period of time due the minor vibration that is generally present in piping systems and causes thread wear.
- Twin-thread Nuts - Clamps for pipe ODs 65mm to 116mm have M8+M10 twin-thread suspension nuts (as shown), for flexibility.
- Side bolts have a slotted-cross head for convenience.
- Custom designed stainless steel (SS 304 / 316) split clamps are available on request.

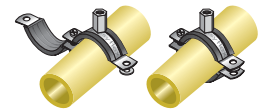
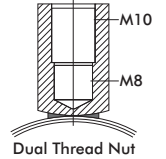

**Material :** Steel, EPDM

**Finish :** Electro galvanized post manufacture.

**Other Options :** Epoxy Powder Coated finish (Suffix 'PC')  
Hot Dip Galvanised finish (Suffix 'HDG')

**Compliance - EG to ASTM B633 SC3  
BS 1706 FE/ZN 12**

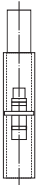
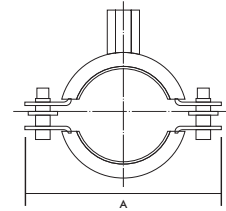

Model No.	Size (inches)	Dia (mm)	Range (mm)	Dimension (mm)		Thick. (mm)	Break Load Kgs	Safe Load Kgs
				A				
EFRLC018	3/8"	15	15-19	60		1.2	450	150
EFRLC022	1/2"	22	20-25	65		1.5	450	150
EFRLC028	3/4"	28	26-30	70		1.5	450	150
EFRLC035	1"	35	32-36	85		1.5	450	150
EFRLC040	1 1/4"	42	38-43	92		1.5	450	150
EFRLC048	1 1/2"	48	47-51	98		1.5	450	150
EFRLC054		54	53-58	104		1.5	450	150
EFRLC060	2"	60	60-64	110		1.5	450	150
EFRLC063		63	63-66	115		1.5	450	150
EFRLC070		70	68-72	120		1.5	450	150
EFRLC075	2 1/2"	75	74-80	125		1.5	600	200
EFRLC083		83	81-86	139		1.5	600	200
EFRLC090	3"	90	87-92	146		1.5	600	200
EFRLC100	3 1/2"	100	99-105	156		1.5	600	200
EFRLC110		110	107-112	166		2	600	200
EFRLC115	4"	115	113-118	171		2	600	200
EFRLC125		125	125-130	181		2	600	200
EFRLC133		133	131-137	184		2	600	200
EFRLC140	5"	140	138-142	196		2	600	200
EFRLC150		150	148-153	206		2	600	200
EFRLC160		160	159-166	216		2	600	200
EFRLC168	6"	168	168-172	224		2	600	200
EFRLC200	8"	200	200-212	256		2	900	300

## Ordering

For any of piping other than steel, please select EFRLC model based on the actual outer pipe diameter. Selecting on the basis of nominal sizes for these pipes can result in errors on account of the large number of schedules prevalent.

Model No.	Copper (inches)	Steel (Sch 40)		UPVC / PE	ABS
		Inches	mm		
EFRLC018	15, 18		16		
EFRLC022	22	1/2"	22	20	DN15 (21.4)
EFRLC028	24, 28	3/4"	28	25	DN20 (26.8)
EFRLC035	35	1"	35	32, 38	DN25 (33.6)
EFRLC040	42	1 1/4"	42	40, 43	DN32 (42.3)
EFRLC048		1 1/2"	48	45	DN40 (48.3)
EFRLC054	54			54	
EFRLC060	64	2"	60	60	DN50 (60.4)
EFRLC063					
EFRLC070	67, 70			70	
EFRLC075	76	2 1/2"	75	75	DN65 (75.4)
EFRLC083	80			83	
EFRLC090		3"	90	90	
EFRLC100	102, 105			102	DN80 (88.9)
EFRLC110	108			110	
EFRLC115		4"	115	115	DN100 (114.3)
EFRLC125	125			125	
EFRLC133				135	
EFRLC140		5"	140	140	DN125 (140.2)
EFRLC150				152	
EFRLC160	159			160	
EFRLC168	167	6"	168		DN150 (168.3)
EFRLC200	206			200	
EFRLC220		8"	219	220, 225	DN200 (225.0)
EFRLC250				250	DN225 (250.4)
EFRLC315					DN300 (315.5)

- Due to policy of continual improvement, the specifications are subject to change without prior notice.
- Measurements are subject to 5% tolerance.
- To achieve good sound suppression do not over load fitting.