

CLAMPING PIPE ATTACHMENT

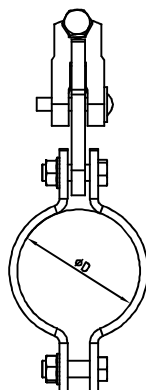

- Function:** Used for fast fixing main pipe, used for single pipe transverse or longitudinal seismic, suitable for pipe arbitrary Angle connection, fixed connection slot parts can be cast.
- Material:** Carbon Steel
- Finish:** Electro-galvanized
- Approvals:** Underwriters' Laboratories Listed in the U.S. (UL), Canada (CUL), for use with standard steel pipe sizes 1" to 8".
- Ordering:** Specify Size

| Item | Size (inches) | D (mm) | Support Pipe | Assembly longitudinal and transverse loads | | | | | |
|------|---------------|--------|--------------|--|-------------------|------------------|--------------------|-------------------|------------------|
| | | | | Minimum Load (lbs) | Minimum Load (kg) | Minimum Load (N) | Maximum Load (lbs) | Maximum Load (kg) | Maximum Load (N) |
| GJZC | 2" | 61 | 1" Pipe | 680 | 306 | 3020 | 1494 | 673 | 6650 |
| GJZC | 2-1/2" | 76 | 1" Pipe | 680 | 306 | 3020 | 1494 | 673 | 6650 |
| GJZC | 3" | 90 | 1" Pipe | 680 | 306 | 3020 | 1494 | 673 | 6650 |
| GJZC | 4" | 115 | 1" Pipe | 680 | 306 | 3020 | 1494 | 673 | 6650 |
| GJZC | 5" | 141 | 1" Pipe | 1370 | 617 | 6090 | 3014 | 1356 | 13400 |
| GJZC | 6" | 168 | 1" Pipe | 1370 | 617 | 6090 | 3014 | 1356 | 13400 |
| GJZC | 8" | 220 | 1" Pipe | 1370 | 617 | 6090 | 3014 | 1356 | 13400 |